

Clark>Dietz

Engineering Quality of Life®



CITY OF GLENDALE

PRIVATE PROPERTY INFLOW AND INFILTRATION REDUCTION PROGRAM



AGENDA

- › INTRODUCTIONS
- › MMSD
- › PROJECT BACKGROUND
- › PHASE 1 – DATA GATHERING AND DESIGN
- › PHASE 2 – CONTRACTED LATERAL REHABILITATION
- › 2024 CONSTRUCTION PROJECT EXAMPLES
- › NEXT STEPS
- › QUESTIONS



INTRODUCTIONS





INTRODUCTIONS

PLEASE REACH US AT:
PPII@clarkdietz.com

ClarkDietz

Engineering Quality of Life™



Steve Wlahovich
Construction Manager



CJ Beyer, PE
Project Manager



Sam Yarnot
Construction Engineer



Brandon Flunker, PE CFM
Design Manager



MILWAUKEE METROPOLITAN SEWERAGE DISTRICT

MMSD protects public health and the environment through world-class, cost-effective water resource management, leadership, and partnership.

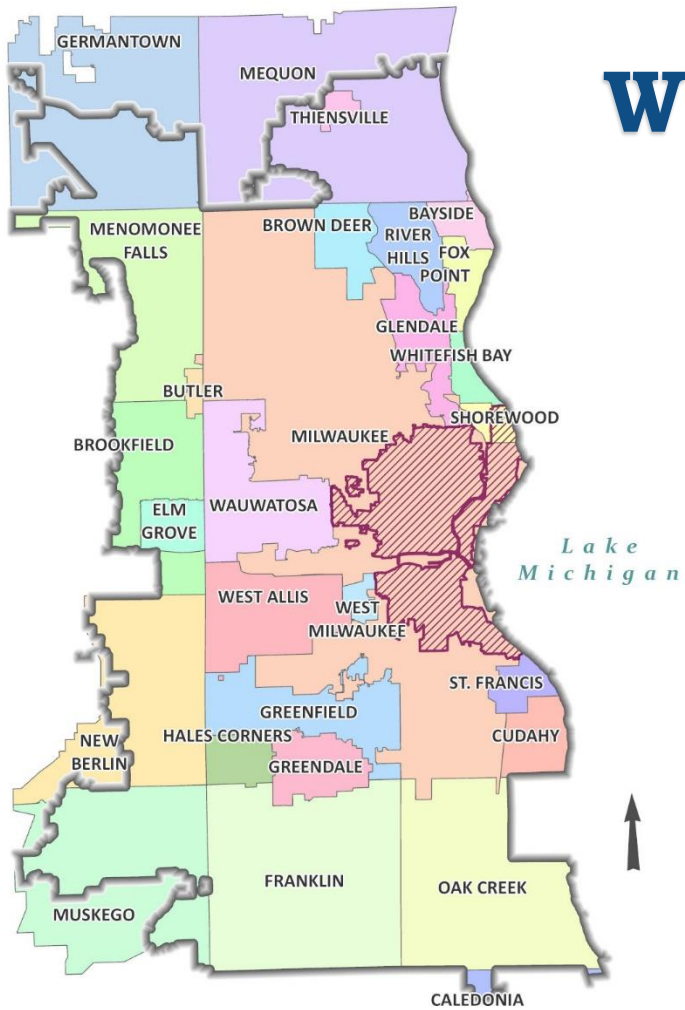

Who Does MMSD Serve?

1.1 Million Customers

28 Municipalities

411 Square Miles

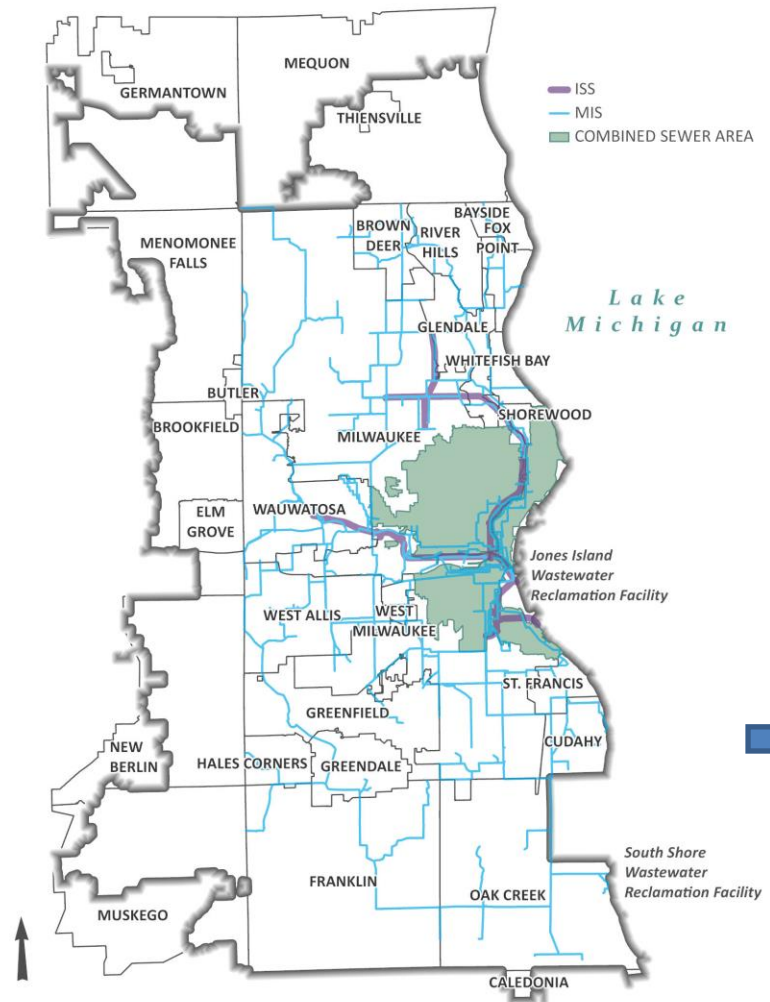

Where Does The Water Go?

300

Miles Of MMSD Sewers

3,000

Miles of Municipality Owned Sewers



3,000

Miles of Private Sanitary Sewer

What is Infiltration & Inflow?

Clearwater
=
rain and/or
groundwater



Infiltration

Clearwater that enters the sanitary sewer through **cracks and defects** in pipes.

Ex. Root Intrusions



Inflow

Clearwater that enters the sanitary sewer through **direct pipe connections**.

Ex. Connected Downspouts

MMSD FUNDED - GLENDALE PPII PROGRAM

- › PPI Investigation and Sanitary Sewer Study prepared for the City of Glendale in March 2021
 - Identified areas within the City most at risk for PPII issues
 - Selected 3 sub-sewersheds to address including the Crestwood Neighborhood
- › The Glendale PPII project will reduce clearwater from the sanitary sewer system in your neighborhood helping lower flows within the system during wet weather events.





PHASE 1 – DATA GATHERING AND DESIGN

- Right of entry agreements for televising
 - Due by march 28th to city hall
- Lateral televising
 - April/may
- Lateral condition assessment
 - Follow up letter to residents with roes for rehab
 - May/June
- Right of entry agreements for rehab
 - June/July
- Design plans for lateral rehab
 - July/august
- Contractor procurement for phase 2
 - TBD



PHASE 1 – LATERAL CONDITION ASSESSMENT

- Free sanitary lateral inspection (\$400 - \$800 value)
- Free “report card” or “health report” for your sanitary lateral
- Televising truck parked on the street accessing manholes with equipment
- No expected service interruptions during televising





PHASE 1 - FOLLOW UP AND DESIGN

- › Review lateral rehab recommendations with homeowners
 - Homeowners have the choice to continue participation into phase 2, or withdraw from the program
- › Develop construction documents for phase 2

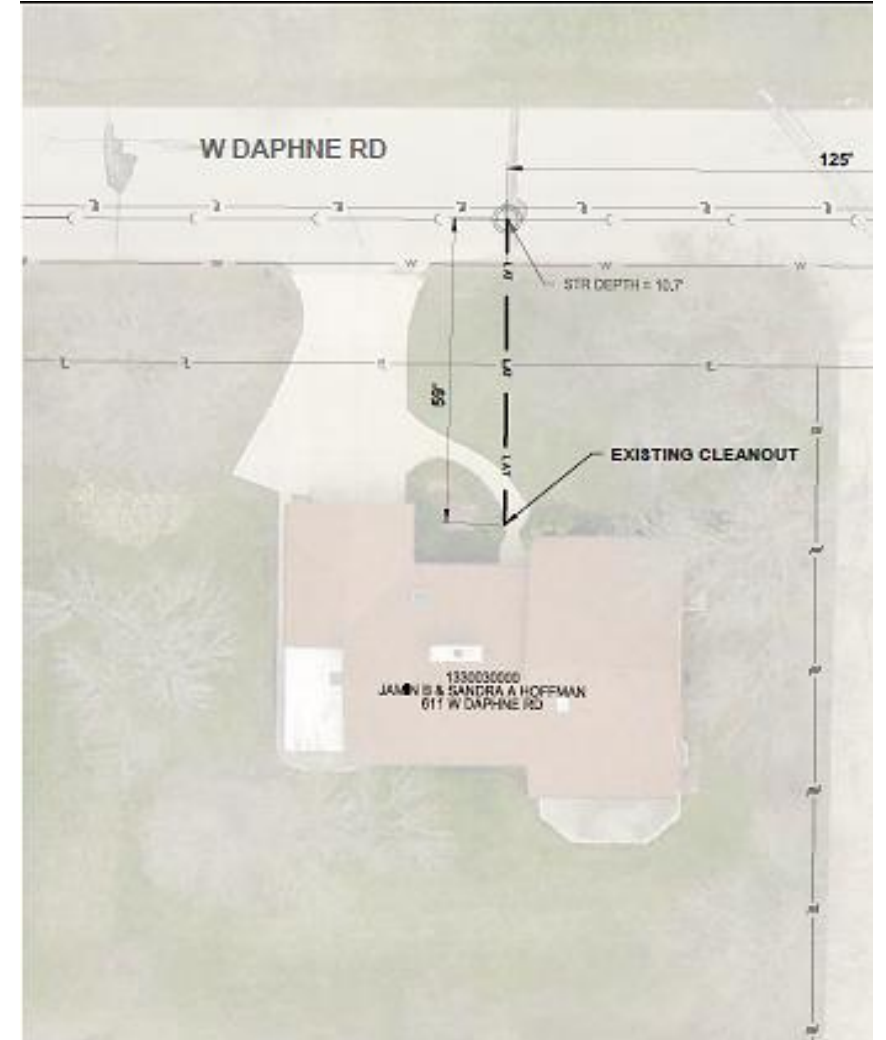



PHASE 2 – LATERAL REHABILITATION

- Phase 2 participation will require new right-of-entry agreement due to nature of this work
- Construction will commence under the supervision of the city of glendale, its consultant, and mmsd
- Work to be warrantied for a period of 3 years





PHASE 2 – LATERAL REHABILITATION

- Contractor will visit home and develop a rehab plan with the homeowner and engineer, for full understanding of approach

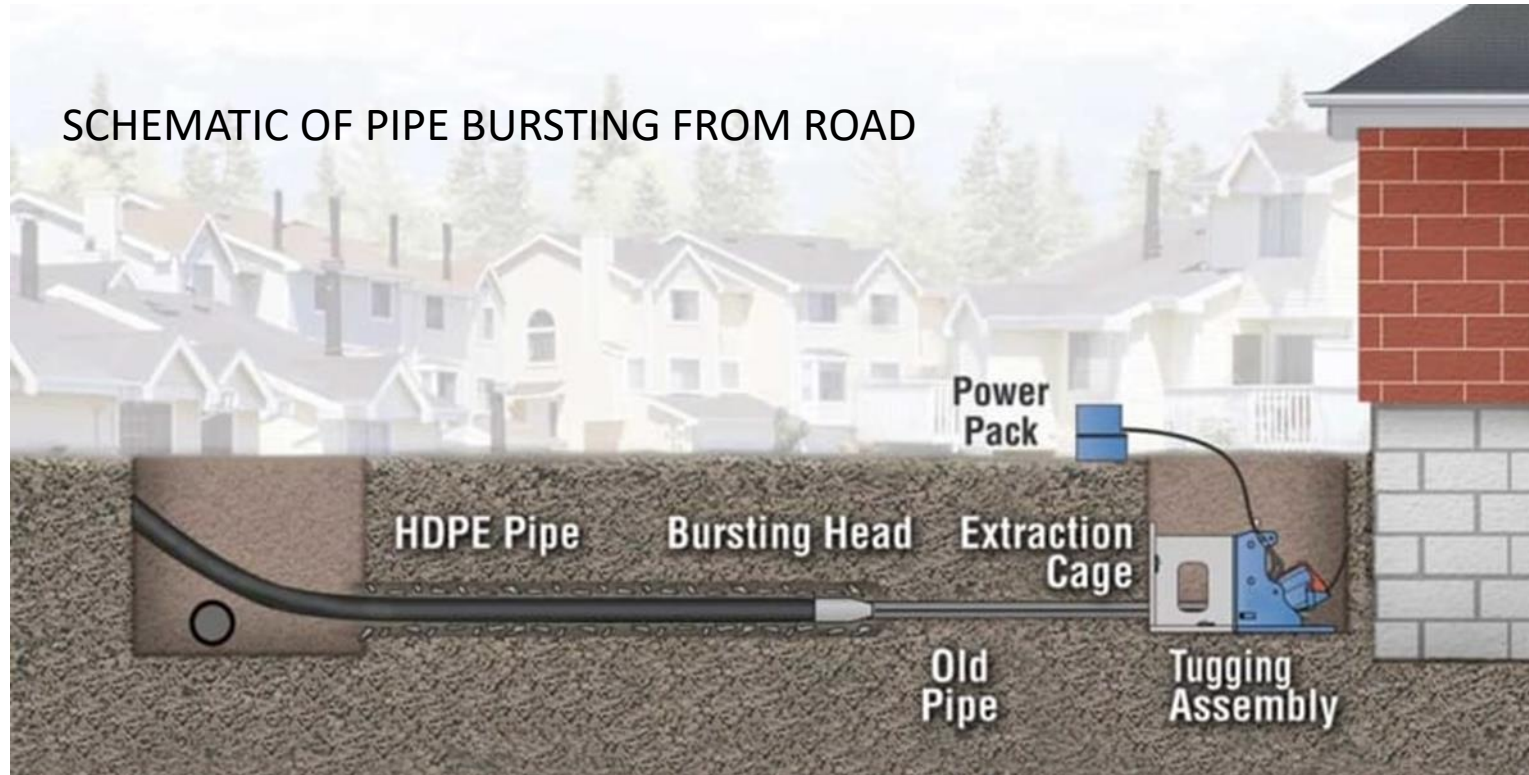

2024 CONSTRUCTION PROJECT EXAMPLES





NEXT STEPS

- › Right of entry agreements for lateral televising
 - DUE MARCH 28th, 2025
- › Resident notice for televising work
- › Televising
- › Resident follow up letter with lateral evaluation
 - Right of entry agreement for rehab work
- › Resident notice for construction work
 - TBD



QUESTIONS?

Please e-mail PPH@clarkdietz.com with any questions, concerns, or comments at any time.

THANK YOU FOR ATTENDING